



Henleaze Terrace, Henleaze, BS9 4AS

Prices From £299,950

GOODMAN  
& LILLEY



THE INDEPENDENT SALES, LETTINGS & LAND AGENTS

## Henleaze Terrace, Henleaze, BS9 4AS

**\*\*Only Four Remaining Please Call To Avoid Disappointment\*\***

Excellent situated in the popular Henleaze area of Bristol and built by Churchill is this development of one and two bedroom apartments that feature fitted kitchens with built in oven, hob and fridge/freezer, generous living rooms, spacious bedrooms and shower rooms. There is a lift to all floors and a wonderful owners lounge with ample space to relax and enjoy some company.

This apartment is situated on the first floor and is a one bedroom.

There's a winning combination of design and safety in both the kitchen and bathroom. Tiled and colour co-ordinated, it is specifically designed to give you convenience and peace of mind.

Call, Click or Come in and visit our experienced sales team- 0117 2130777 / [henleaze@goodmanlilley.co.uk](mailto:henleaze@goodmanlilley.co.uk)

Local Authority: Bristol Council Tel: 0117 922 2000

Services: Water, Drainage and Electric.

- Churchill Retirement Living
- Exclusively for the over 50s
- Excellent Bristol Location
- Fully Fitted Kitchens
- Double Glazed Windows
- Modern Shower Rooms
- One Bedroom Apartments
- 24 hour Careline support system

### Location

Henleaze is an ancient village in the county of Bristol. The River Trym meanders through the town, just a couple of miles from the City of Bristol with its many attractions.

The village offers a good choice of supermarkets,

shopping, restaurants and other local amenities, all within easy walking distance from the development.

Henleaze Lake is home to the local swimming club and has been there for almost 100 years. Old Quarry Park is a short distance away, offering the perfect location for a gentle stroll in the fresh air.

This affluent area in Bristol maintains a calm, sophisticated ambiance, making it a popular destination to retire. There are all the usual leisure facilities close by, as well as the more practical shops and services including doctors' surgeries and vets.

### Safety and Security

A 24 hour emergency Careline system is also provided via a discreet personal pendant alarm and shower room call point. In an emergency this system provides direct contact to either your Lodge Manager, when on duty, or a member of the Careline team, 24 hours a day, 365 days a year.

A camera entry system is installed and can be operated via a standard TV set from your apartment. This allows you to view a visitor before letting them in at the main entrance door simply by changing channels on your TV set.

An intruder alarm is fitted to the front door of every apartment and in ground floor apartments sensors are also fitted throughout.

Sophisticated fire and smoke detection systems are fitted in all apartments and throughout the communal areas.

Both the intruder and fire alarm systems are connected to the Careline system.

And finally, but most importantly, there is the Lodge Manager, who is responsible for the

effective and smooth running of the development. We hope you will come to see him or her as a neighbour you may call upon. You'll find them a great help, from answering day to day queries to keeping an eye on your apartment if you go away.

### Further Information

Please call us on 0117 2130777 with any questions and we can arrange your visit.

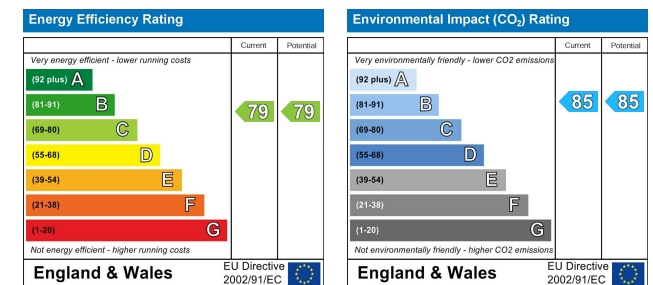

### Bristol

156 Henleaze Road, Henleaze  
Bristol, BS9 4NB  
0117 213 0777

[www.goodmanlilley.co.uk](http://www.goodmanlilley.co.uk)



# One Bedroom Apartment

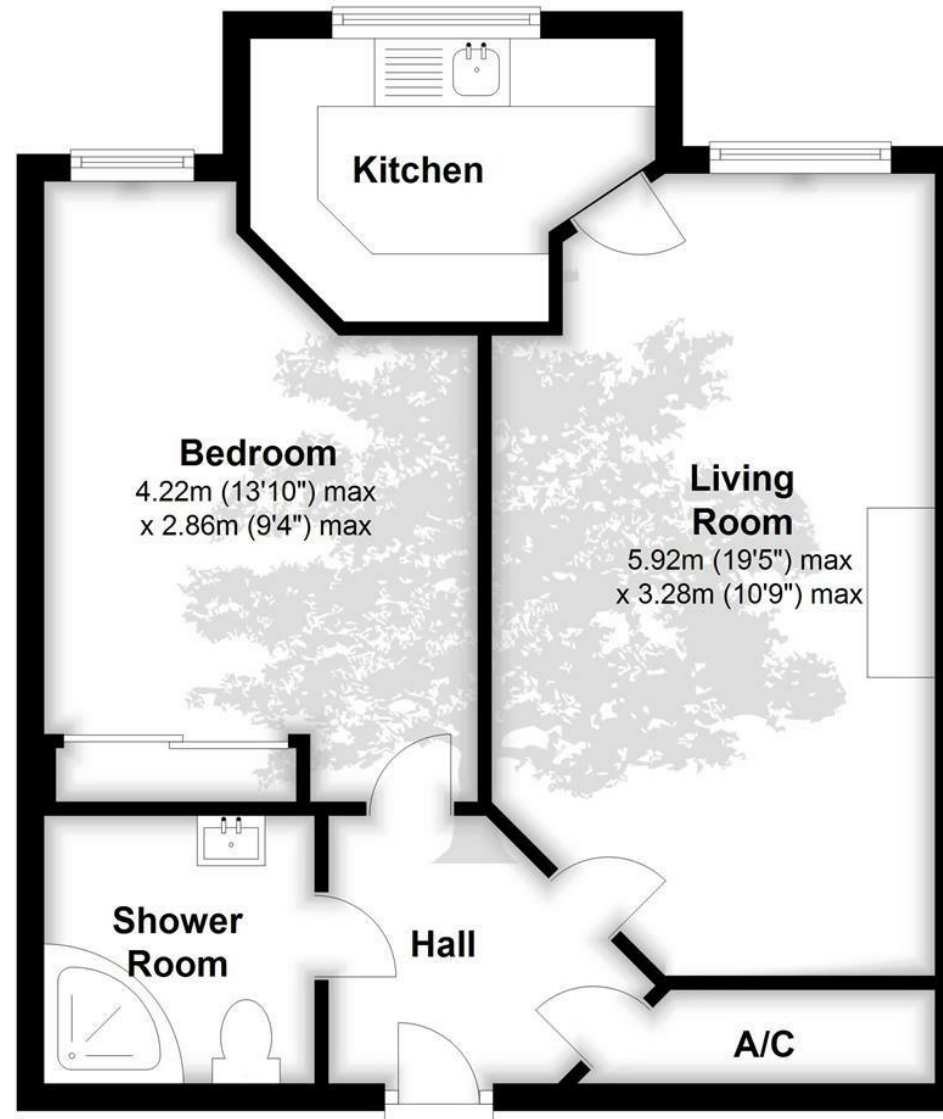

These particulars are for general guidance only. They do not form or constitute any part of an offer or contract. Goodman & Lilley has not carried out structural surveys of the property. The services, appliances or specific fittings mentioned in these details have not been tested. Every attempt is made to ensure accuracy, however all photographs, measurements, floor plans and distances are for illustrative purposes only. They must not be relied upon when purchasing carpets and or other fixtures and fittings. Lease details, service charges and ground rents are given as a guide only. They should be checked and confirmed by a licensed solicitor prior to exchange of contracts. The copyright of all details, photographs and floor plans remain exclusive to Goodman & Lilley.